

HIOMA

SUORAT TEROITUSLAIKAT

DxTxH

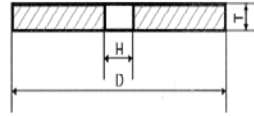

D	T	H
100	4	16
100	4,5	20
100	6	32
100	7	16
100	8	32
100	10	32
105	4,7	22
120	4	20
120	5	20
125	4	32
125	5	32
125	6	32
125	7	22
150	2	32
150	2,5	32
150	3	22
150	4	22
150	4,2	22
150	4,7	22
150	5	32
150	6	32
150	8	32
150	10	32
150	12	32
175	6	32
175	8	32
175	10	32
175	13	32
175	13	70
175	16	32
180	2	32
180	2,4	32
180	4	32
180	6	32
180	6	38
200	2	32
200	2,5	32
200	3	32
200	3,5	32
200	4	32

D	T	H
200	5	32
200	6	32
200	8	32
200	10	32
200	12	127
200	13	32
200	15	127
200	16	32
225	5	60
230	7	32
230	8	32
230	10	32
250	3	32
250	4	32
250	5	32
250	6	32
250	7	32
250	8	32
250	9	32
250	10	32
250	10	76
250	11	32
250	12	32
250	13	32
250	14	32
250	15	32
250	16	32
300	5	32
300	5	127
300	6	32
300	6	127
300	8	32
300	8	127
300	10	32
300	12	32
300	13	32
300	14	32
300	15	32
300	16	32
300	19	32

HIOMA

SUORAT HIOMALAIKAT (HL) 48 - 250

D x T x H

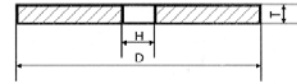

D	T	H
48	5	10
48	12	10
48	16	10
50	20	10
50	25	20
75	13	13
75	19	13
75	20	20
80	13	13
80	20	22
100	20	32
100	65	20
100	25	16
110	3	22
125	20	13
125	20	32
125	25	32
125	30	32
125	50	32
140	100	32
150	13	32
150	14	32
150	15	32
150	19	32
150	20	32
150	25	32
150	30	32
150	32	32
150	40	32
150	45	32
150	50	32
150	50	51
150	55	32
160	20	32
175	18	32
175	19	25
175	20	32

D	T	H
175	25	32
175	30	32
175	32	32
175	50	32
175	80	32
175	100	32
180	55	32
185	25	32
200	20	32
200	25	32
200	30	32
200	30	76
200	32	32
200	32	127
200	50	32
200	55	76
200	100	32
203	6	32
203	10	32
203	20	32
205	75	140
225	11	32
225	20	32
250	19	32
250	19	70
250	20	32
250	25	32
250	25	76
250	30	32
250	30	63
250	32	32
250	40	32
250	40	76
250	42	32
250	50	32
250	55	32
Jatkuu...		

HIOMA

SUORAT HIOMALAIKAT (HL) 300 - 600

YLEISHIONTA JA ROUHINTA

DxTxH

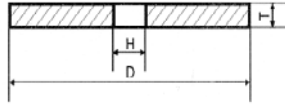

D	T	H
300	20	32
300	20	127
300	22	32
300	25	32
300	25	127
300	30	32
300	30	76
300	32	32
300	32	76
300	32	127
300	35	32
300	38	25
300	40	32
300	40	38
300	40	50
300	40	76
300	50	32
300	80	210
350	13	32
350	25	127
350	32	127
350	40	32

D	T	H
350	40	38
350	40	76
350	40	127
350	50	32
350	50	127
350	55	127
400	60	127
400	60	250
400	50	38
400	50	127
400	40	127
450	15	127
450	20	127
450	80	203
500	50	38
500	50	160
500	50	203
500	60	127
500	75	203
500	78	305
600	80	300
600	63	203

HIOMA

MUUT HIOMALAIKAT (HL)

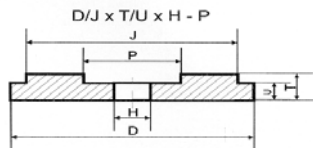

D/J	T/U	H	P
450/414	60/51	200	230

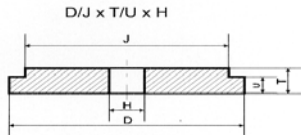

D/J	T/U	H
300/280	50/30	127

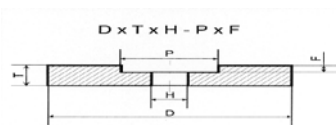

D	T	H	P	F
200	40	32	100	15
175	50	50	105	37
60	19	10	20	6

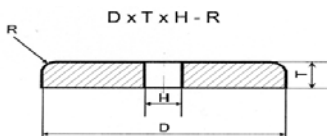

D	T	H	R
125	40	16	8
185	25	32	10

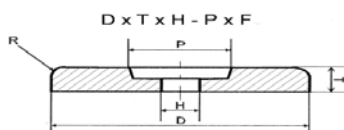

D	T	H	P	F
185	55	32	120	20

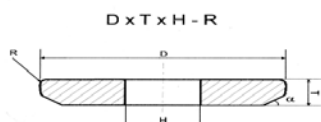

D	T	H	R
350	55	127	10

(Veistosahan haketusterien teroitus)

HIOMA

HIOMARENKAAT (HR)

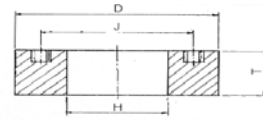
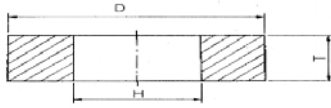
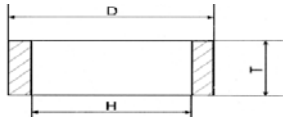

D	T	H	
100	40	38	Liima
100	50	38	Liima
125	60	55	4xM8
130	40	60	Liima
150	50	120	Liima
150	60	80	4xM8
150	72	55	4xM8
175	80	135	4xM8
190	60	120	4xM8
190	60	120	6xM10
190	60	120	Liima
200	25	60	4xM8
200	25	100	6xM10
200	30	100	Liima
200	50	100	Liima
200	80	100	Liima
200	100	160	Liima
200	110	160	Liima
240	70	135	Liima
250	25	152	Liima
250	25	152	4xM8
250	40	130	4xM10
250	45	120	4xM10
250	100	200	Liima
250	120	200	Liima
255	25	120	VR
255	40	125	Liima
255	40	155	Liima
255	50	125	Liima
255	60	125	Liima
255	60	160	Liima
280	50	160	Liima
280	50	180	Liima
280	50	180	4xM16
280	120	180	Liima
300	51	153	6xM10
300	100	235	Liima
300	120	250	Liima
300	125	240	Liima
300	125	250	Liima

LATTIAHIOMARENKAAT (HR)

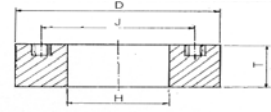
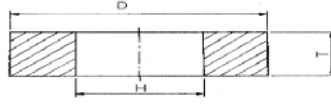
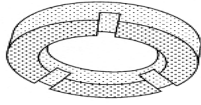

D	T	H	Jakoympyrä	Kiinnitys	Laatu	Kone
240	70	135	J200	4xM10	79C16-N7B1	
250	60	130		Liima	79C24-J10B1	
255	35	155		Liima	79C16-N6B1	
255	80	155	J200	4xM12	79C16-N7B2 79C24-J10B2 79C30-N7B1	Bewag Dynapac BS 10 Miretta
280	50	180	J220	4xM16	79C30-M5...M8B1	Cassani
300	60	200		Liima	79C20-N7B1 79C20-L9...L12B1	Mira
300	60	200	J270	4xM10	79C20-L9...L12B1	
300	80	210	J255	4xM12	79C20-L9...L12B1	
300	80	210	J255	5xM12	79C36-K6...K10B1	
400	50	220		Liima	79C16-M7B2	Dynapac BS 50
400	50	220	J330	4xM12	79C24-M7B2	
400	60	152		Liima	79C16-L7B1	ABS, Aramis
400	60	250	3-ura	Liima	79C16-L5B1	Aramis S135 Raimond Wetrok
400	60	250	J320 / 3-ura	3xM12	79C16-L5B1 79C36-L6B1	
500	80	400		12xM12	79C60-P95B2	
500	80	405		8xM10	70C46-R9B2	
500	80	420	J460	4xM12	70C80-R9B2	

HIOMA

HIOMARENKAAT PIKAKIINNITYKSELLÄ (MPK)

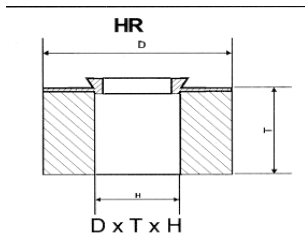

D	T	H	
100	50	38	MPK
125	60	55	MPK
130	40	60	MPK

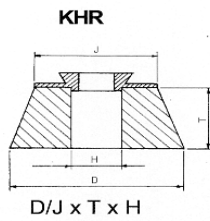

D/J	T	H	
100/90	40	38	MPK
120/100	50	38	MPK
150/130	50	60	MPK

MPK - kiinnitystyyny

Koko
100 x M 14
100 x W 5/8"
130 x M14
130 x W 5/8"

HIOMARENKAAT OLKAKIINNITYKSELLÄ

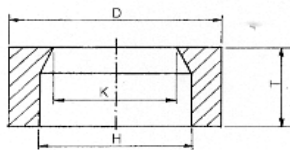

D x T x H/J

D	T	H/K
425	100	320/280

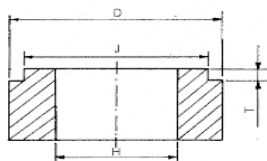

D x T x H - J x F

D	T	H	J	F
280	120	180	250	8

HIOMA

SUORAT KUPPILAIKAT (SKL)

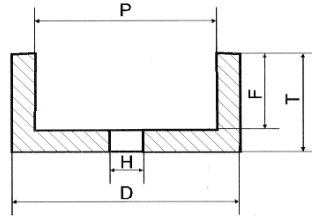

D x T x H x - P x F

D	T	H	P	F
51	34	20	39	24
51	34	M14	39	24
76	42	20	45	22
76	42	M14	46	28
76	42	22	46	28
76	45	22	45	25
76	50	32	45	35
95	50	20	74	37
100	45	32	75	25
100	50	20	63	30
100	50	32	57	36
100	50	32	63	30
100	100	22	60	80
100	110	22	60	90
125	50	32	98	35
125	76	30	110	51
127	63	32	80	50

D	T	H	P	F
150	50	32	50	25
150	60	32	127	55
150	63	32	130	53
150	75	40	112	60
150	75	63	127	55
150	76	32	100	64
150	76	32	110	55
150	76	32	127	61
150	76	32	127	55
150	76	35	127	55
150	80	32	100	64
150	80	32	110	60
175	50	32	100	16
175	50	50	105	37
175	75	20	117	58
176	76	32	117	58
176	76	50	117	58
200	100	32	150	80
200	100	32	160	80
200	100	34	180	76
250	100	50	160	80

Keraamiset laikat:

80	40	20	70	30
100	50	20	80	40

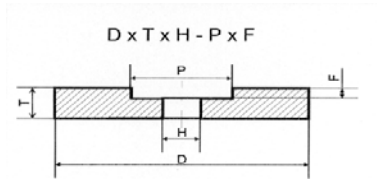

D	T	P	F
76	35	45	15
76	35	45	15
80	30	40	15
80	35	47	23
100	20	60	5

Laatuesimerkkejä 70 C 46 - K 7 B 1

70 C 46 - K 42 B 1

SUORAT KUPPILAIKAT TERÄSTUELLA (TTSKL)

D x T x H x - P x F

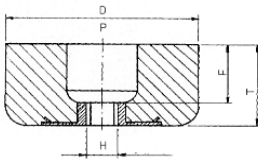

D	T	H	P	F
76	42	M14	46	28
85	65	M20	45	40
85	65	M20	45	48
100	65	M20	50	45
100	110	M20L	50	90
100	110	M20L	55	90
130	55	M20	60	40
150	65	M20	60	40

TERÄSSELKÄISET SUORAT KUPPILAIKAT (TSSKL)

D x T x H x - P x F

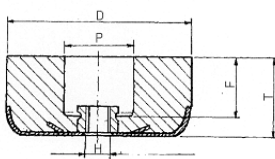

D	T	H	P	F
130	55	M20	60	40
130	65	M20	60	50

LAUTASLAIKAT (Muoto 12)

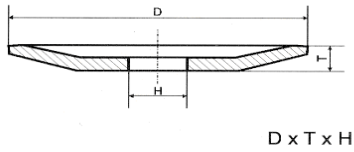

Keraaminen

D	T	H
150	18	20
175	18	32
200	20	32

KARTIOKUPPILAIKAT (KKL)

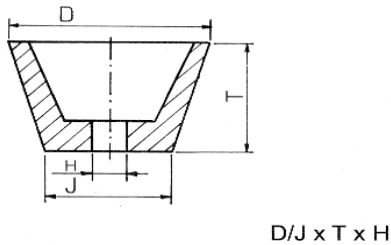

D/J	T	H
75/60	40	22
75/60	40	M14
110/90	55	22
150/110	50	32
150/110	80	32
160/120	55	20

KARTIOKUPPILAIKAT TERÄSTUELLA (TTKKL)

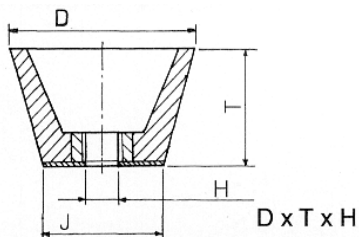

D	T	H
110/90	55	W5/8
110/90	55	M14

TERÄSSELKÄISET KARTIOKUPPILAIKAT (TSKKL)

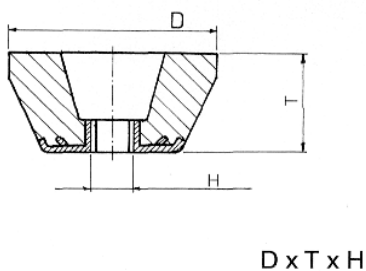

D	T	H
100	50	M14
100	50	W5/8
125	50	M14
125	50	W5/8
130	51	M16
150	50	M14
150	50	W5/8

HIOMAPÄÄT (HP)

Muoto 16

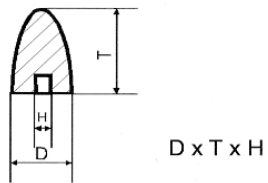

D	T	H
50	70	W 5/8
50	70	M 14
58	83	W 1/2
58	83	W 5/8

Muoto 18

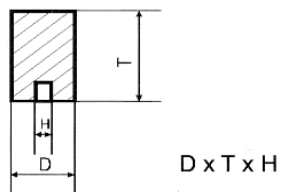

D	T	H
32	63	W 1/2
40	76	UNC 1/2
45	50	W5/8
72	84	W 5/8

Muoto 18 R

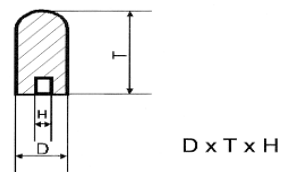

D	T	H
40	60	UNC 3/8
64	80	W 1/2
64	80	W 5/8

Muoto 19

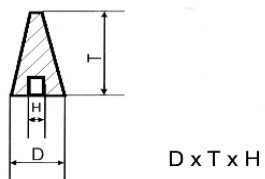

D	T	H
47	77	W 5/8

KARALAIKAT (KL)

Muoto W

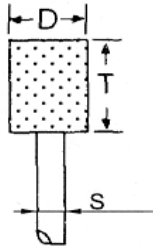

D x T x S

W188
W205
52B
W208
W221
W238
W237

D	T	S
13	40	6
20	25	6
20	30	6
20	50	6
25	40	6
40	40	6
40	25	6

Muoto A3



D x T x S

E 1
A 3

D	T	S
25	62	6
25	70	6

Muoto A11

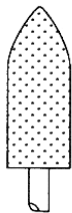

D x T x S

52E2
52E1
A11

D	T	S
20	25	6
20	63	6
22	50	6

HIOMASEGMENTIT (HS)

Muoto 1 / 3101

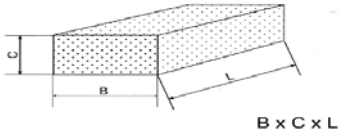

B	C	L
50	20	100
50	25	100
56	18	150
60	20	120
60	25	120
65	20	100
80	25	150
120	40	180
120	40	210
140	44	180

Muoto 2 / 3109

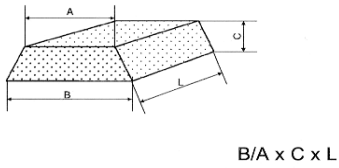

B/A	C	L
60/54	22	108
65/58	20	70
70/64	25	150
102/90	36	152
103/84	38	180
103/94	38	180

Muoto 3 / 3105

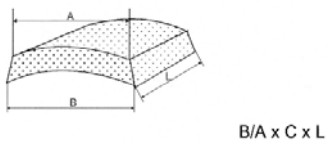

B/A	C	L	R
50/45	16	105	75
50/45	21	105	75
79/70	21	70	185
85/82	25	125	125
90/81	28	150	170

HIOMASEGMENTIT (HS)

Muoto 4 / 3102

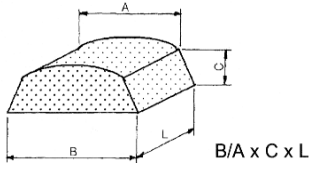

B/A	C	L	R
65/58	25	100	210
90/76	30	127	175
108/85	32	150	

Muoto 5 / 3108

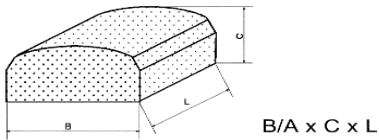

B/A	C	L
120/100	40	205

Muoto 6

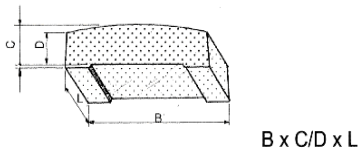

B	C/D	L
66	18/14	60

Muoto 7 / 3104

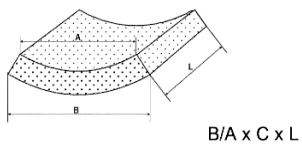

B/A	C	L	R
95/72	25	160	150

Muoto 8

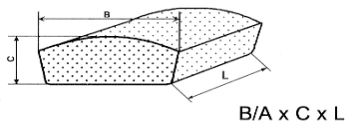

B/A	C	L
4 1/2"	1 3/4"	7 1/2"
(114)	(45)	(90)

HIOMA

MUUT HIOMASEGMENTIT

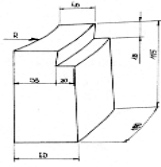

(12 kpl/ympyrä; R=300)				
HS K12	180/115	60/115	40/20	18

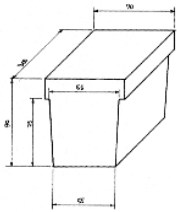

LPHK	300	90/75	67/55	

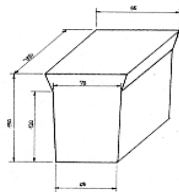

LPHK	300	150/125	82/67	



HS	160	75/150	116/65	60	12
----	-----	--------	--------	----	----

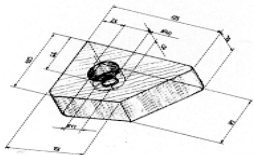

HS	125/75	75	17/40	60

HIOMA

LATTIAHIONTASEGMENTIT

LHS

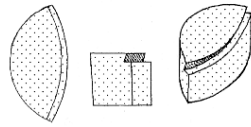

Pehmeä laatu	C 30 - P
	C 30 - R
	C 30 - S
	C 30 - T
	C 30 - TE
Kova laatu	C 30 - UE

Muut karkeudet C 16 - C 1000

LHS 6K

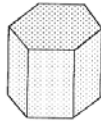

64	95
64	105

HS 500 /300
Dynapac

80 60

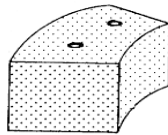

Pehmeä laatu	70 C 16 - 11
	70 C 16 - 10,5
	70 C 16 - 10
	70 C 16 - 9,5
	70 C 16 - 9
	70 C 16 - 8,5
Kova laatu	70 C 16 - 8

Muut karkeudet C 24 - C 36

LATTIAHIONTAPÄÄT

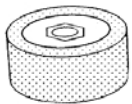

D x T x H

D	T	H	Laatuesimerkit
100	60	M 14	79 C 16 - L 7 B1
130	51	M 16 Tremix	79 C 20 - L 7 B1

RUHKAKIVET

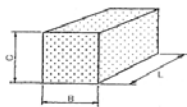

B	C	L	Laatuesimerkit:
50	50	70	
50	50	100	Errut 79 C 20 - L 13 B1
50	50	200	79 C 36 - M 13 B1

KAHVALLISET RUHKAKIVET

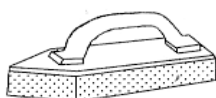
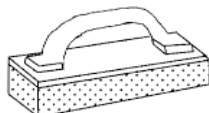

B/A	C	L
105/95	42	200

B	C	L
100	40	230

Laatuesimerkki: **79 C 20 - M 7 B1**

KOVASIMET, AUKAISU- JA TEROITUSKIVET

Neliö

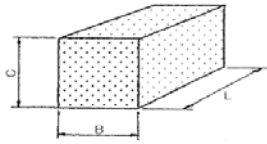

B	C	L
13	13	150
25	25	200
30	30	150
50	50	70

Suorakaide

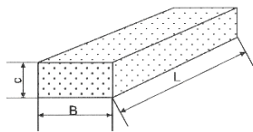

B	C	L
25	13	100
50	25	200
50	25	300

Suorakaide/kombi

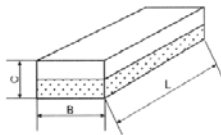

B	C	L
50	25	200

Kolmio

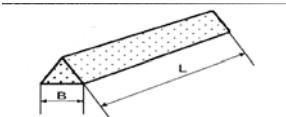

B	L
13	150

Puolipyöreä

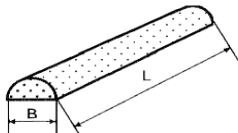

B	L
13	150

Pyöreä

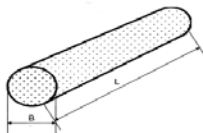

B	L
6	150
13	150
16	200

Kiekk

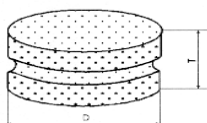

D	T
100	50